

J/7 Mainsail Logo

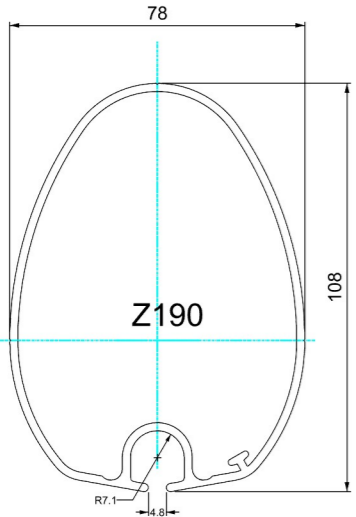

Spar Builder - US Spars (Z-Spars in Europe)
Mast Section - Z190
Tack set-up - 60mm
Tack set-back - 33mm
Gate

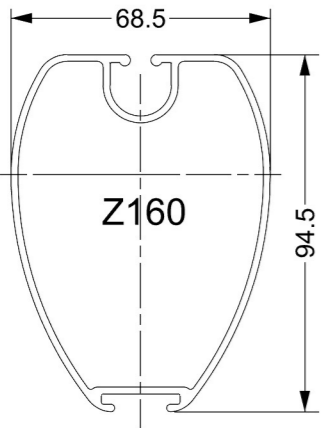

Boom Section - Z160

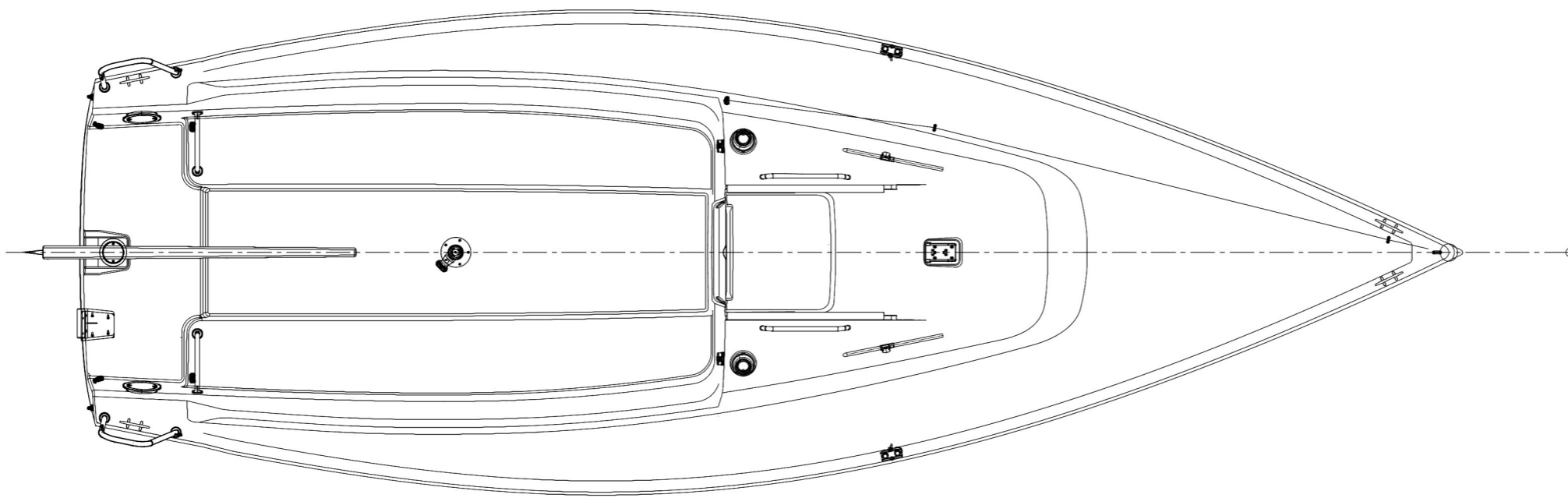
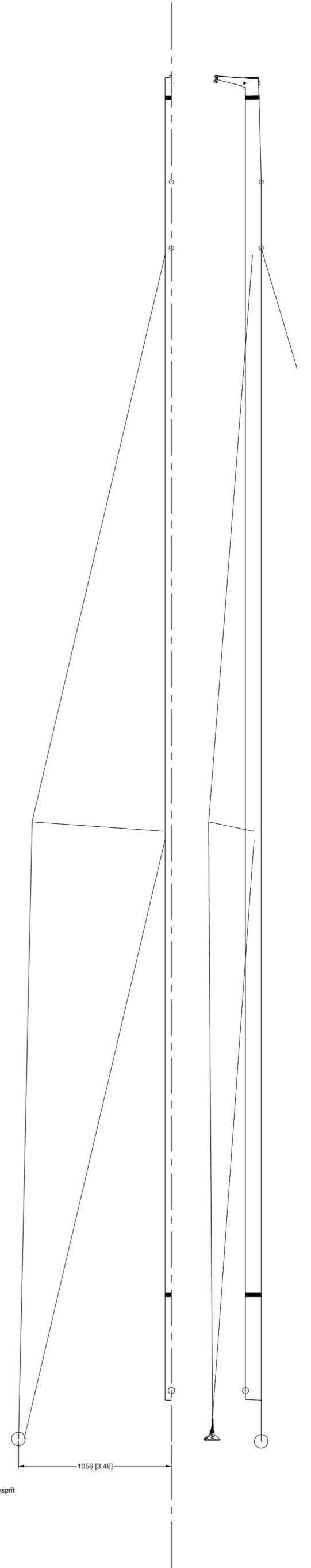
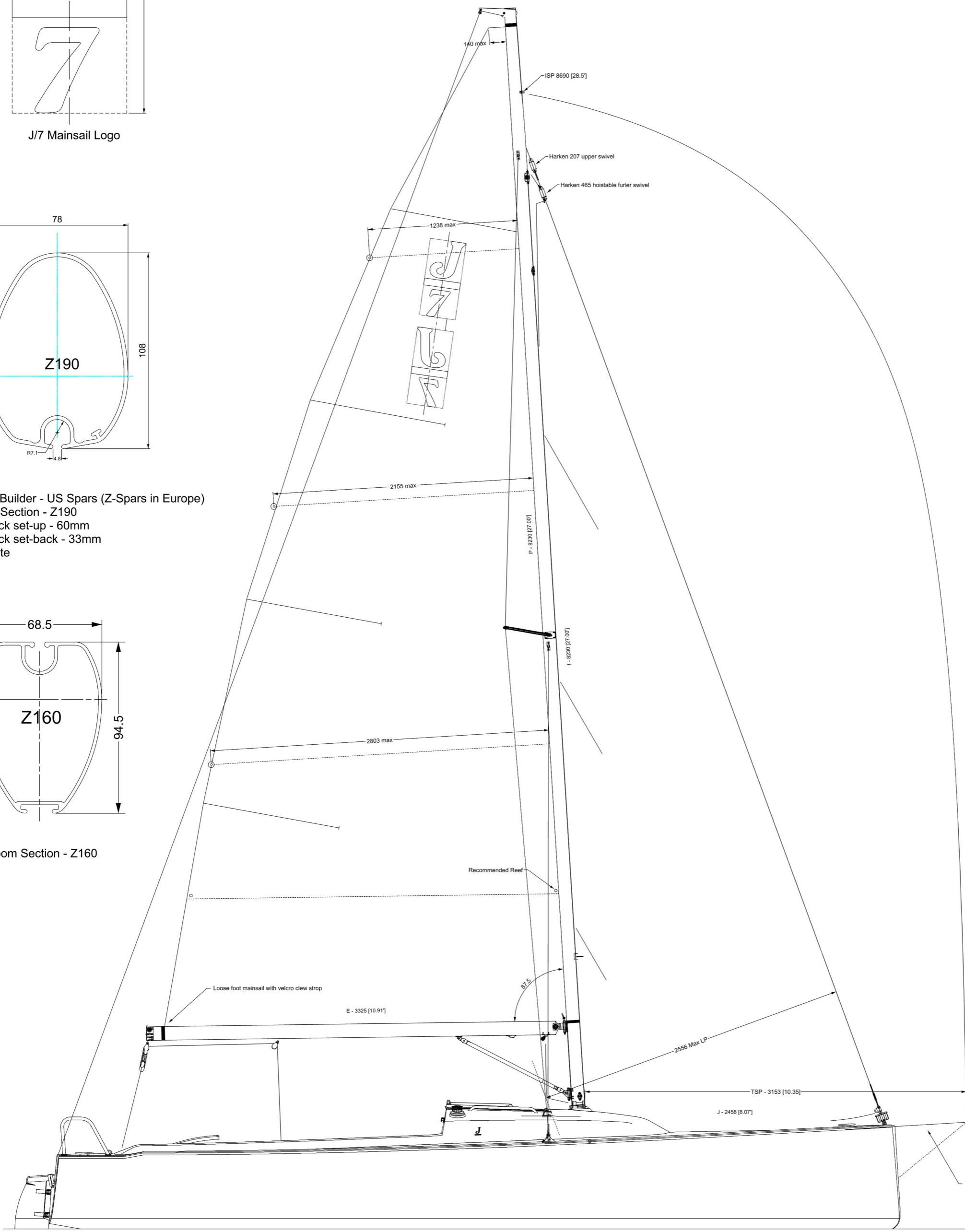

Principal Dimensions

	(m)	(ft)
LOA	7.04	23.11
LWL	6.35	20.84
Beam	2.47	8.11
Draft	1.16	3.80
DSPL	1,044 kg	2,300 lbs
100% SA	23.8 sqm	256 sqft
I	8.23	27.00
ISP	8.69	28.50
J	2.46	8.07
P	8.23	27.00
E	3.32	10.91
TPS/SPL*	3.15	10.35
Max A-Sail Area*	46 sqm	495 sqft
Mast Air Draft	10.12	33.21
Mast Length	9.14	30.00

* For optional bowsprit & asymmetric spinnaker.



ALL DIMENSIONS IN MM (FT)
THIS DOCUMENT IS THE PROPERTY OF J/BOATS, INC. AND IS NOT TO BE USED OR REPRODUCED IN WHOLE OR IN PART WITHOUT WRITTEN PERMISSION.

TITLE	J/7 Rig Plan				
SIZE	For				
DESIGNER	R. Alan Johnstone	DATE	04-04-2025	SCALE	1:30
					A2

04/25/25